

Butterfly-shaped Cylindrical Lock ▶ 30 Series



Please order according to the diagram

1 Select the type and parameters in the order of for ordering.

Model (● Code)

CASFA



Discounted Price

Quantity 1~9 10~

Price 100% Separate Quotation

Price Excluding Tax (Yuan)



CAD 2D

Code	Type	Lip Height	Lock Cylinder	Material			Surface Treatment		
				Base	Handle	Deadbolt	Base	Handle	Deadbolt
CASFA	30 Series	13	Straight	ZDC		Q235	Spray Painted (Black)		Zinc Plated
CASFF		26.5	Lock Cylinder	ZDC5		S45C	Chrome Plating		Zinc Plated
CASFG							Matt Black Finish		

Lip Height : 13

CASFA

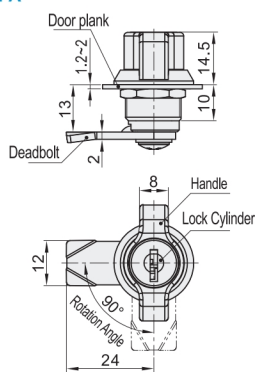

● Cutout Dimensions

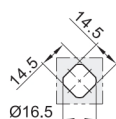

● Features:

- Convenient Handle Rotation for Unlocking
- The deadbolt rotates 90° to achieve the opening or locking function;
- Universal for both left-handed and right-handed door openings.
- IP Protection Rating: IP54

1 Comes with 2 keys.

Lip Height : 27

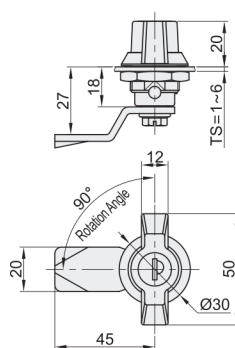

● Cutout Dimensions

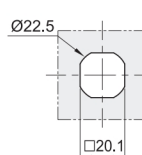

● Features:

- Convenient Handle Rotation for Unlocking
- The deadbolt rotates 90° to achieve the opening or locking function;
- Universal for both left-handed and right-handed door openings.

1 Deadbolt Hole Dimensions: 8 × 8

1 Comes with 2 keys.

Lip Height : 26.5

CASFF
CASFG

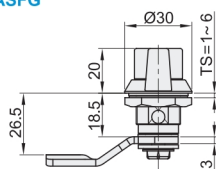

● Cutout Dimensions

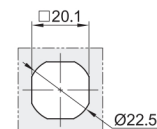

● Features:

- Convenient Handle Rotation for Unlocking
- The deadbolt rotates 90° to achieve the opening or locking function;
- Universal for both left-handed and right-handed door openings.

1 Deadbolt Hole Dimensions: 8 × 8

1 Comes with 2 keys.

Model	Reference Weight
Code	(kg)
CASFA	0.064
CASFF	0.145
CASFG	