

Keyless Trapezoidal Toothed Synchronous Wheel ▶ H Type Tooth Pitch 12.7



Please order according to the diagram

①~④ Select the type and parameters in the order of for ordering

Model(①Code) - Number Teeth - Wheel Shape - Shaft Hole Specification dH7
VJEKC-H075 - 15 - E - d14



Discounted Price
 Quantity 1~9 10~
 Price 100% Separate Quotation
 Price Excluding tax (Year)



CAD 2D 3D

Code	Wheel Type	Belt Width	Tooth Spacing	Material		Surface Treatment			Using an Expansion Sleeve
				Wheel	Flange	Expansion Sleeve	Wheel	Flange	
VJEKC	H075	19.1	12.7	A7075	Aluminum Alloy	S45C	Natural Anodizing	Black Oxide Finish	See Synchronous Wheel Overview
VJEKB				S45C	SPCC		Black Oxide Finish		
VJEKA				Electroless Nickel Plating					
VJELZ	H100	25.4		A7075	Aluminum Alloy		Natural Anodizing	Black Oxide Finish	
VJELY				S45C	SPCC		Black Oxide Finish		
VJELX				Electroless Nickel Plating					
VJEMW	H150	38.1	A7075	Aluminum Alloy	Natural Anodizing	Black Oxide Finish			
VJEMV			S45C	SPCC	Black Oxide Finish				
VJEMU			Electroless Nickel Plating						
VJENT	H200	50.8	A7075	Aluminum Alloy	Natural Anodizing	Black Oxide Finish			
VJENS			S45C	SPCC	Black Oxide Finish				
VJENR			Electroless Nickel Plating						

Standard Tooth Profile

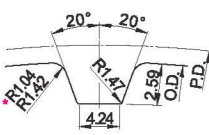

□ Size R with * is suitable for up to 19 teeth.

Wheel Shape E Shaped

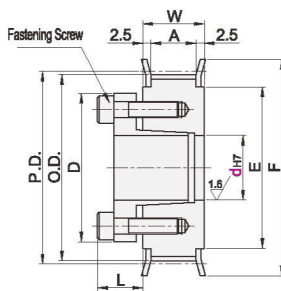

Wheel Shape F Shaped

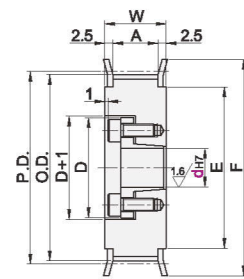

Model	Number Teeth	Wheel Type	Shaft Hole Specification dH7(Select according to the Expansion Sleeve Bore Size Chart)								P.D.	O.D.	F	E	A	W
			H075		H100		H150		H200							
Code			E Shaped CT Expansion Sleeve	F Shaped CH Expansion Sleeve	E Shaped CT Expansion Sleeve	F Shaped CH Expansion Sleeve	E Shaped CT Expansion Sleeve	F Shaped CH Expansion Sleeve	E Shaped CT Expansion Sleeve	F Shaped CH Expansion Sleeve						
VJEKC-H075	14	E	12~17	12~17	12~17	12~17	15~17	15~17	16~17	16~17	56.60	55.22	61	45	H075 A:21 W:26	
VJEKB-H075	15		14~20	14~20	14~20	14~20	15~20	15~20	16~20	16~20	60.64	59.27	67	50		
VJEKA-H075	16		14~20	14~20	14~20	14~20	15~20	15~20	16~20	16~20	64.68	63.31	70	56		
VJELZ-H100	17		F	14~25	14~25	14~25	14~25	15~25	15~25	16~25	16~25	68.72	67.35	80	60	H100 A:27 W:32
VJELY-H100	18			14~25	14~25	14~25	14~25	15~25	15~25	16~25	16~25	72.77	71.39	80	60	
VJELX-H100	19			14~32	14~32	14~32	14~32	15~32	15~32	16~32	16~32	76.81	75.44	87	67	
VJEMW-H150	20			14~32	14~32	14~32	14~32	15~32	15~32	16~32	16~32	80.85	79.48	87	67	
VJEMV-H150	21			14~35	14~32	14~35	14~32	15~35	15~35	16~35	16~35	84.89	83.52	95	75	
VJEMU-H150	22			14~35	14~32	14~35	14~32	15~35	15~35	16~35	16~35	88.94	87.56			
VJENT-H200	24			19~35	19~32	19~35	19~32	19~35	19~35	19~35	19~35	97.02	95.65	104	84	H150 A:40 W:45
VJENS-H150	25	19~35		19~32	19~35	19~32	19~35	19~35	19~35	19~35	101.06	99.69	111	90		
VJENR-H150	26									105.11	103.73	111	90			
	28									113.19	111.82	123	102	H200 A:54 W:59		
	30									121.28	119.90	127	105			
	32	20~35	20~32	20~35	20~32	20~35	20~35	20~35	20~35	129.36	127.99	135	115			
	34									137.45	136.07	144	125			
	36									145.53	144.16	152	130			

Expansion Sleeve Bore Size

dH7	Allowable Maximum Torque N.m		D		(L)
	CT Expansion Sleeve	CH Expansion Sleeve	CT Expansion Sleeve	CH Expansion Sleeve	
12	48	23	32	31	10.5
14	73	37	35	36	12
15	78	39	36	37	
16	83	42	37	38	13
17	88	45	38	39	
18	154	48	43	40	
19	163	49	45	42	
20	171	97	46	46	
22	186	110	48	47	14
24	206	121	50	49	
25	216	124	52	51	
28	353	141	54	53	15.5
30	382	149	57	56	
32	412	163	59	58	16.5
35	451	173	63	61	