

Keyless Synchronous Pulley ▶ T5 Type Tooth Pitch 5.0



Please order according to the diagram

①~④ Select the type and parameters in the order of for ordering

Model(①Code) - Number Teeth - Wheel Shape - Shaft Hole Specification dH7
VLGNG-T5100 - 25 - F - d8



Discounted Price

Quantity 1~9 10~
Price 100% Separate Quotation

Price Excluding Tax (Yen)



CAD 2D 3D

Code	Wheel Type	Belt Width	Tooth Spacing	Material			Surface Treatment			Using an Expansion Sleeve
				Wheel	Flange	Expansion Sleeve	Wheel	Flange	Expansion Sleeve	
VLGNG	T5100	10	5.0	Aluminum Alloy	S45C	Natural Anodizing	-	-	See Synchronous Wheel Overview	
VLGMH	T5150	15								
VLGLJ	T5200	20								
VLGKL	T5250	25								

Standard Tooth Profile

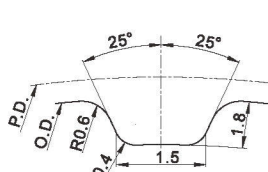

Wheel Shape E Shaped

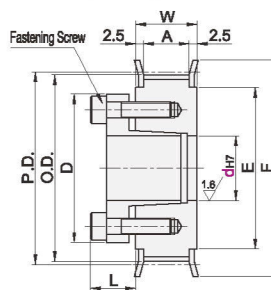

Wheel Shape F Shaped

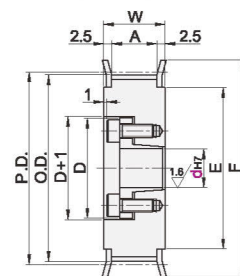

3.2

Model	Number Teeth	Wheel Type	Shaft Hole Specification dH7 (Select according to the Expansion Sleeve Bore Size Chart)								P.D.	O.D.	F	E	A	W	
			T5100		T5150		T5200		T5250								
Code			E Shaped CT Expansion Sleeve	F Shaped CH Expansion Sleeve	E Shaped CT Expansion Sleeve	F Shaped CH Expansion Sleeve	E Shaped CT Expansion Sleeve	F Shaped CH Expansion Sleeve	E Shaped CT Expansion Sleeve	F Shaped CH Expansion Sleeve							
VLGNG-T5100	22	E	8		-	-	-	-	-	-	35.01	34.25	40	27	T5100 A:11 W:16		
	24		8-10	8	10	8	-	8	-	8	38.20	37.40	45	30			
	25										39.79	39.00					
	26			8~12		10~11~12	8-10	12	8-10	12	8-10	41.38	40.60	48	35	T5150 A:17 W:22	
	28			10~15		10~15		10~15	10~11~12	10~15	10~11~12	44.56	43.75	52	36		
	30											47.75	46.95				
	VLGMH-T5150		32						10~14		10~14	50.93	50.10	55	40	T5200 A:22 W:27	
	VLGLJ-T5200		34	F	10~17		10~17	10~12	12~17	10~18	12~17	10~18	54.11	53.25	61		45
	VLGKL-T5250		36										57.30	56.45	61		45
	40									10~19		10~19	63.66	62.85	67	50	
	44		12~25		12~25		12~25	12~25	12~25	12~25	70.03	69.20	74	58	T5250 A:27 W:32		
	48		12~28		12~28	12	12~28	12~28	12~28	12~28	76.39	75.55	83	63			
	50		12~32		12~32		12~32	12~32	12~32	12~32	79.58	78.75	87	67			
	60		12~35		12~35		12~35	12~35	12~35	12~35	95.49	94.65	99	80			

Expansion Sleeve Bore Size

dH7	Allowable Maximum Torque N.m		D		(L)
	CT Expansion Sleeve	CH Expansion Sleeve	CT Expansion Sleeve	CH Expansion Sleeve	
8	16	8.5	25.5	24.5	8.5
10	39	18	30	29	10.5
11	43	20	31	30	
12	48	23	32	31	
14	73	37	35	36	12
15	78	39	36	37	
16	83	42	37	38	13
17	88	45	38	39	
18	154	48	43	40	
19	163	49	45	42	14
20	171	97	46	46	
22	186	110	48	47	
24	206	121	50	49	
25	216	124	52	51	15.5
28	353	141	54	53	
30	382	149	57	56	
32	412	163	59	58	16.5
35	451	173	63	61	