

Synchronous Pulley ▶ Width Specified Type · MXL/XL/S2M/S3M/S5M Type



①~⑥ Select the type and parameters in the order of for ordering

Model(①Code) - ②Number Teeth - ③Wheel Shape - ④W - ⑤Shaft Hole Specification - ⑥Shaft Hole Specification dH7 - ■ Optional Processing ■ KC() WC.WD...
 VMJCR-MXL - 20 - A - W30 - p - d10 - WC

Please order according to the diagram



CAD 2D/3D

Code	Wheel Type	Tooth Spacing	Material Wheel	Material Flange	Surface Treatment	Threaded Hole Size Chart						
VMJCR	MXL	2.032	A2017	A5052	Natural Anodizing	M	Attachment (Lighting Screws) (Pitch Diameter)	MXL	XL	S2M	S3M	S5M
VMJBS	XL	5.08				M3	M3×3	3~5	—	3~5	4~5	—
VMJAT	S2M	2.0				M4	M4×3	6~18	6~12	6~22	6~17	6~12
VMJZU	S3M	3.0				M5	M5×4	19~20	13~17	—	18~32	13~17
VMJYV	S5M	5.0				M6	M6×5	—	18~30	—	—	18~30
			M8	M8×6	—	31~47	—	—	31~38			

Wheel Shape

A Shaped

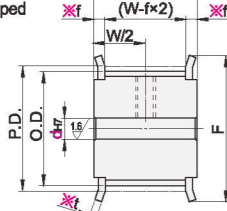

※ MXL,S2M,S3M: f=2.0 t=1.0; XL,S5M: f=2.5 t=1.6.

Shaft Hole Specification

H Round Hole

P Round Hole + Threaded Hole

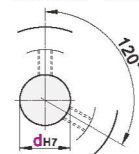

Model Code	Number Teeth	Wheel Type	W Minimum Unit 1	Shaft Hole Specification	Shaft Hole Diameter dH7 Minimum Unit 1	P.D.	O.D.	F	
VMJCR-MXL	14	A	15~100 W≤d×15	H	P	3-4	9.06	8.55	12
	15					3-4	9.70	9.19	
	16					3-5	10.35	9.84	14
	17					3-5	11.00	10.49	
	18					3-5	11.64	11.14	
	19					3-5	12.29	11.78	
	20					4-6	12.94	12.43	18
	21					4-6	13.58	13.07	
	22					4-6	14.23	13.72	
	23					4-7	14.88	14.37	20
	24					4-7	15.52	15.02	
	25					4-7	16.17	15.66	
	26					4-8	16.82	16.31	22
	27					4-8	17.46	16.96	
	28					4-8	18.11	17.60	
	30					4-10	19.40	18.90	25
	32					4-10	20.70	20.19	
	34					4-10	21.99	21.48	28
	36					5-12	23.29	22.78	
	38					5-12	24.58	24.07	
40	5-12	25.87	25.36	30					
42	5-12	27.17	26.66						
44	5-13	28.46	27.95	32					
46	5-13	29.75	29.24						
48	5-15	31.05	30.54	35					
50	5-15	32.34	31.84						
60	5-20	38.81	38.30	44					
72	5-20	46.57	46.06	52					
VMJBS-XL	16	A	15~100 W≤d×15	H	P	6-13	25.87	25.36	32
	18					6-15	29.11	28.60	36
	19					6-15	30.72	30.22	40
	20					8-16	32.34	31.83	
	22					8-20	35.57	35.07	45
	24					8-22	38.81	38.30	
	25					8-22	40.43	39.92	48
	26					8-23	42.04	41.53	
	28					8-25	45.28	44.77	55
	30					10-30	48.51	48.00	
	32					10-30	51.74	51.24	61
	36					10-38	58.21	57.70	67
40	10-47	64.68	64.17	74					
VMJAT-S2M	14	A	15~100 W≤d×15	H	P	3-4	8.91	8.40	12
	15					3-4	9.55	9.04	
	16					3-5	10.19	9.68	14
	18					3-5	11.46	10.95	
	20					3-6	12.73	12.22	16
	22					3-6	14.01	13.50	18
	24					3-7	15.28	14.77	20
	25					3-7	15.92	15.41	22
	26					3-8	16.55	16.04	
	28					3-8	17.83	17.32	25
	30					3-8	19.01	18.59	
	32					4-10	20.37	19.86	28
36	4-10	22.92	22.41						
40	4-12	25.46	24.96	30					
44	5-13	28.01	27.50	32					
48	5-15	30.56	30.05	35					
50	5-16	31.83	31.32						
60	5-22	38.20	37.69	44					
VMJZU-S3M	14	A	15~100 W≤d×15	H	P	4-6	13.37	12.61	16
	15					4-6	14.32	13.56	18
	16					4-7	15.28	14.52	20
	18					4-8	17.19	16.43	
	20					4-8	19.10	18.34	22
	22					4-10	21.01	20.25	
	24					4-10	22.92	22.16	25
	25					4-11	23.87	23.11	
	26					5-11	24.83	24.07	28
	28					5-13	26.74	25.98	
	30					6-14	28.65	27.89	32
	32					6-16	30.56	29.80	35
36	6-18	34.38	33.62	40					
40	8-23	38.20	37.44	44					
44	8-25	42.02	41.25	48					
48	8-25	45.84	45.07	50					
50	8-28	47.75	46.98	52					
60	8-32	57.30	56.53	61					
VMJYV-S5M	14	A	20~100 W≤d×15	H	P	6-10	22.28	21.32	26
	16					7-12	25.46	24.50	32
	20					7-16	31.83	30.87	36
	24					7-20	38.20	37.24	45
	25					7-20	39.79	38.83	
	30					10-26	47.75	46.79	52
	32					10-28	50.93	49.97	55
	36					10-30	57.30	56.34	61
	40					10-38	63.66	62.70	67

Optional Processing	Model	Change the stop screw angle to 90°	Non-rieveted Flange	Riveting Only on One Side of the Flange	Cut-off Flange	Add screw holes
	Code	KC ()	WC	WD	FC ()	MC ()
Technical Specification						
		Selection Method KC90 ① Change the stop screw angle to 90°	Selection Method WC ① Non-rieveted Flange (only the synchronous wheel body is shipped, no flange included)	Selection Method WD ① Riveting flange on one side	Selection Method FC30 Reduced Flange Height. ① Minimum Unit 0.5	Selection Method MC20-WA5 ① Applicable only for shaft hole specification P. ② Comes with 4 hexagon socket head cap screws. ③ When WA is not specified, WA=(W-MC)/2.